

The PIKO extrusion is useful in interior design, furniture, exhibitions.



Fixture Certified to NSF 2 standards  
when assembled by KLUŠ



#### Closet Rated

- Super small - only 0.39" / 10mm wide
- Narrow line of light
- Designed to reach an IP67 waterproof rating

#### FINISH :

Silver anodized ☐



Fill empty fields

Product nr.	
Fixture type	
Company	
Job name	
Date	

## TECHNICAL SPECIFICATION

### Application

- The extrusion is designed for use in gaps of various materials with small cross-sections. It can be mounted to the edge of thin planes, glass, plastics etc. used in the furniture, exhibition, etc.

### Assembly

- designed to be mounted to the surface with screws or two-sided adhesive tape.

### Additional information

- the extrusion is suitable for bending into gentle curves, in the plane adjacent to the LED strip
- fast and reliable installation of sealed LED strips "5-KLIK" (LED strip in a special silicone sleeve ensuring increased tightness).
- Ideal for use in bathrooms and other rooms with high humidity.

- space for LED strip: 0.28" / 7.2 mm

#### Extrusion bending

Minimum internal radius  
150 mm / 5.9"

Minimum external radius  
150 mm / 5.9"

- Minimum radius – bending radius which when exceeded causes destruction (deformation, bending or lack of compatibility with other accessories, e.g. covers, end caps, etc.) of the profile.
- Internal radius – refers to the extrusion bent so that the cover is facing the inside of the arch.
- External radius - refers to the extrusion bent so that the cover is facing the outside of the arch.
- Irregular curves are possible after consultation and individual quotation.
- When bending anodized extrusions, one should be aware of cracking of the anode coating (which may be more or less visible depending on the radius).

Possibility of making a linear fixture with IP67 protection, which means the fixture is dustproof and waterproof.

Turn off LED lights during peak day light hours in outdoor applications to avoid excessive heat buildup which will result in diminished LED life.

## TECHNICAL DRAWING

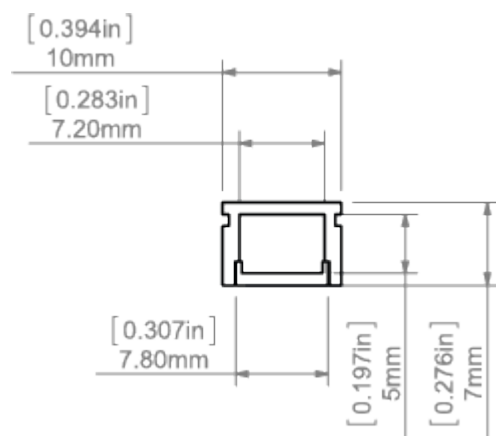

## RELATED PRODUCTS

### COVERS



PIKO Cover  
Ref: 17034  
Ecocity SKU: EX-KL0-FR

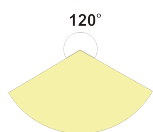

### END CAPS

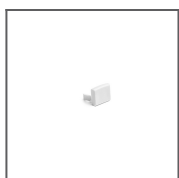

PIKO End cap  
Ref: 24202  
Ecocity SKU: EX-KL0-CAP-1

### ACCESSORIES



6x1.2 Gland  
Ref: 00802

### LED TAPES



Ribbon Star  
ThinLux



Ribbon Star  
SlimLux